

ASSEMBLY INSTRUCTIONS

CRASH PAD KIT HONDA CBR 1000 2017

HP1101-17

KIT

- X1. SPECIFIC BRACKETS + CRASH PAD KIT
- X1. LEFT BRACKET + CRASH PAD
- X1. RIGHT BRACKET + CRASH PAD
- X1. h10mm TEFLON THICKNESS
- X1. M5X25 ALLEN SCREW
- X1. 6mm Ø13 THICKNESS
- X1. 8mm Ø13 THICKNESS
- X2. 27mm Ø13 THICKNESS
- X1. 27mm SPECIAL THICKNESS
- X3. M6X35 ALLEN SCREW
- X3. M6X55 ALLEN SCREW

WWW.BARRACUDAMOTO.COM

ASSEMBLY PROCEDURE:

1. REMOVE THE LOWER PART OF THE HULL. UNSCREW THE ORIGINAL ALLEN SCREWS (SHOWN IN THE DIAGRAM) OF THE ENGINE COVERS.
2. PROCEED BY MOUNTING THE **LEFT** BRACKET USING THE M6X55 ALLEN SCREWS AND 27mm THICKNESSES, USING THE SPECIAL THICKNESS IN THE LOWER HOLE, AS SHOWN IN THE PICTURE. TIGHTEN EVERYTHING.
3. MOUNT THE **RIGHT** BRACKET USING THE M6X35 ALLEN SCREWS AND 6mm AND 8mm THICKNESSES, AS SHOWN.
4. REASSEMBLE THE LOWER PART OF THE HULL, TAKING CARE TO PLACE THE "LETTER H" THICKNESS BETWEEN THE ORIGINAL BRACKET (INDICATED IN THE RED CIRCLE) AND THE HULL, USING THE M5X20 ALLEN SCREW AND THE RUBBER WASHER, AS SHOWN IN THE PICTURE.

LEFT

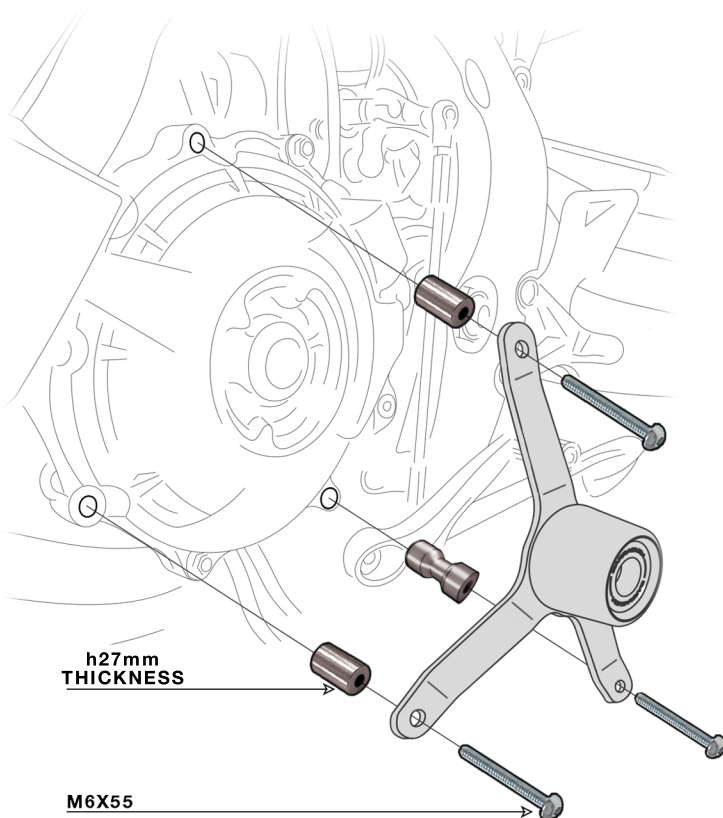

RIGHT

